

# CHANGE ORDER FORM

CHANGE ORDER NUMBER \_\_\_\_\_ 02 \_\_\_\_\_

**PROJECT:** FM 1000: Construction of a new location, non-freeway facility, consisting of grading, structures, base, surfacing, signals and pavement markings. From Proposed US 271 Relief Route, east to FM 1735.

**CONTRACTOR:** James Construction Group, LLC

Contractor is directed to make the following changes to the Contract Documents.

**DESCRIPTION OF CHANGES:** Revise wingwalls at sta. 300+31.83

**ATTACHMENTS:** See Separate list of Attachments

<u>CHANGE IN CONTRACT PRICE</u>	<u>CHANGE IN CONTRACT TIME</u>
1. Original Price: <u>\$ 18,846,843.37</u>	Original Time: <u>383</u> DAYS
2. Total of Prior Change Orders: <u>\$0.00</u>	Total of Prior Change Orders: <u>0</u> DAYS
3. Total Price Prior to Current Change Order: <u>\$ 18,846,843.37</u>	Total Time Prior to Current Change Order: <u>383</u> DAYS
4. Total of Current Change Order: <u>\$2,964.69</u>	Total of Current Change Order: <u>0</u> DAYS
5. New Price Resulting from Current Change Order: <u>\$ 18,849,808.06</u>	New Time Resulting from Current Change Order: <u>383</u> DAYS

**AGREED BY:**

James Construction Group, LLC \_\_\_\_\_  
(Signature) (Date)

PTP Transportation, LLC: \_\_\_\_\_  
(Signature) (Date)

**APPROVED BY:**

Titus County: \_\_\_\_\_  
(Signature) (Date)

Texas Department of Transportation: \_\_\_\_\_  
(Signature) (Date)

Federal Highway Administration: \_\_\_\_\_  
(Signature) (Date)





**FM 1000 – Change Order 02**  
***List of Attachments***

- **Letter to TxDOT – Re: Change Order 02 Justification**
- **Letter to TxDOT – Re: Change Order 02 Price Justification**
- **Letter to TxDOT – Re: Change Order 02 Environmental Assurance Statement**
  
- **Construct Modified Wing Walls at STA 300+31.83**
  - Revised Culvert 13 Plan Sheets
  - James Construction Change Order Request and Pricing Summary
  - Highway 19 Construction Pricing Breakdown
  - TxDOT Average Bid Price



February 5, 2014

Mr. Roger Ledbetter, P.E.  
Area Engineer – Mount Pleasant  
Texas Department of Transportation – Atlanta District  
2210 W. Ferguson  
Mount Pleasant, Texas 75455

RE: Titus County  
CSJ: 1226-04-01  
FM 1000  
**Change Order 02 Justification**

Dear Mr. Ledbetter:

PTP Transportation, LLC, on behalf of Titus County, is submitting for your review and approval Change Order 02 for the subject project. This change order is necessary to provide for payment for modifications to culvert 13 on the project.

Due to limited lateral space in drainage ditches, the culvert inlet and outlet wingwalls have been modified to shorten the length the structure.

All of the costs associated with this change order are summarized in the Cost Report, included with this change order. The breakdown of costs are summarized and discussed on a separate letter under the subject of price justification. If you have any questions regarding this matter, please feel free to contact me at (936) 441-9121.

Sincerely,

**PTP TRANSPORTATION, LLC**

A handwritten signature in black ink that reads 'Rich L. Kronenberger P.E.'.

Richard L. Kronenberger, P.E.  
Director of Construction Services

Attachments  
cc: PTP Transportation, LLC Staff  
File



February 5, 2014

Mr. Roger Ledbetter, P.E.  
Area Engineer – Mount Pleasant  
Texas Department of Transportation – Atlanta District  
2210 W. Ferguson  
Mount Pleasant, Texas 75455

RE: Titus County  
CSJ: 1226-04-01  
FM 1000  
**Change Order 02 Price Justification**

Dear Mr. Ledbetter:

This letter serves as notice that the new pay items and prices below has been reviewed and are considered fair and reasonable for the subject project. The new pay items are as follows:

Item Number		Description	Unit	Unit Price
Item	Desc			
0466	9999	WINGWALL (FW-0)(HW=6FT), Partial	LS	\$3,035.84
0466	2048	WINGWALL (PW)(HW=4FT)	EA	\$7,105.35
0466	2050	WINGWALL (PW)(HW=6FT)	EA	\$7,423.50

This consideration is made based on the justification provided for each item consisting of quotes, previously established labor and equipment rates, and invoices provided. Each Item is discussed in greater detail below.

***0466-9999 WINGWALL (FW-0)(HW=6FT), Partial***

This new item is created to allow for payment of work completed before the wingwall design change was implemented. The pricing justification is based on the attached invoice from Highway 19 Construction for the work completed with allowable markup. After reviewing the invoice, several rates for labor and equipment are in a price per day. This gives some cost savings as the rates per day are lower than a typical per hour charge for eight hours. The pricing for this Item is considered fair and reasonable.

***0466-2048 WINGWALL (PW)(HW=4FT)/ 0466-2050 WINGWALL (PW)(HW=6FT)***

These new item costs are to establish a unit price for new wingwall design. A comparison to the attached state average bid prices of \$7499.55 for Item 0466-2048 and \$8,909.54 for Item 0466-2050 indicates the contractor estimate attached is priced competitively. The pricing also includes allowable markups for the work performed and is considered to be fair and reasonable.

February 5, 2014  
Mr. Roger Ledbetter  
US 271  
Change Order 11 Price Justification  
Page 2

If you have any questions regarding this matter, please feel free to contact me at (936) 441-9121.

Sincerely,

A handwritten signature in black ink that reads "Rich L. Kronenberger P.E." The signature is written in a cursive style with a large initial 'R'.

Richard L. Kronenberger, P.E.  
Assistant Director of Construction Services

cc: PTP Transportation, LLC Staff  
File



February 5, 2014

Mr. Roger Ledbetter, P.E.  
Area Engineer – Mount Pleasant  
Texas Department of Transportation – Atlanta District  
2210 W. Ferguson  
Mount Pleasant, Texas 75455

RE: Titus County  
CSJ: 1226-04-01  
FM 1000  
**Change Order 02 Environmental Assurance Statement**

Dear Mr. Ledbetter:

This letter is to serve as notice that the proposed work on this change order will not affect any of the environmental clearances or commitments for the subject project. The work in this change order includes modifying the end treatments of culvert 13 at STA 300+31.83 to shorten the length of the wingwalls.

If you have any questions regarding this matter, please feel free to contact me at (936) 441-9121.

Sincerely,

**PTP TRANSPORTATION, LLC**

Terry L. Plucker  
Director of Environmental Services

cc: PTP Transportation, LLC Staff  
File

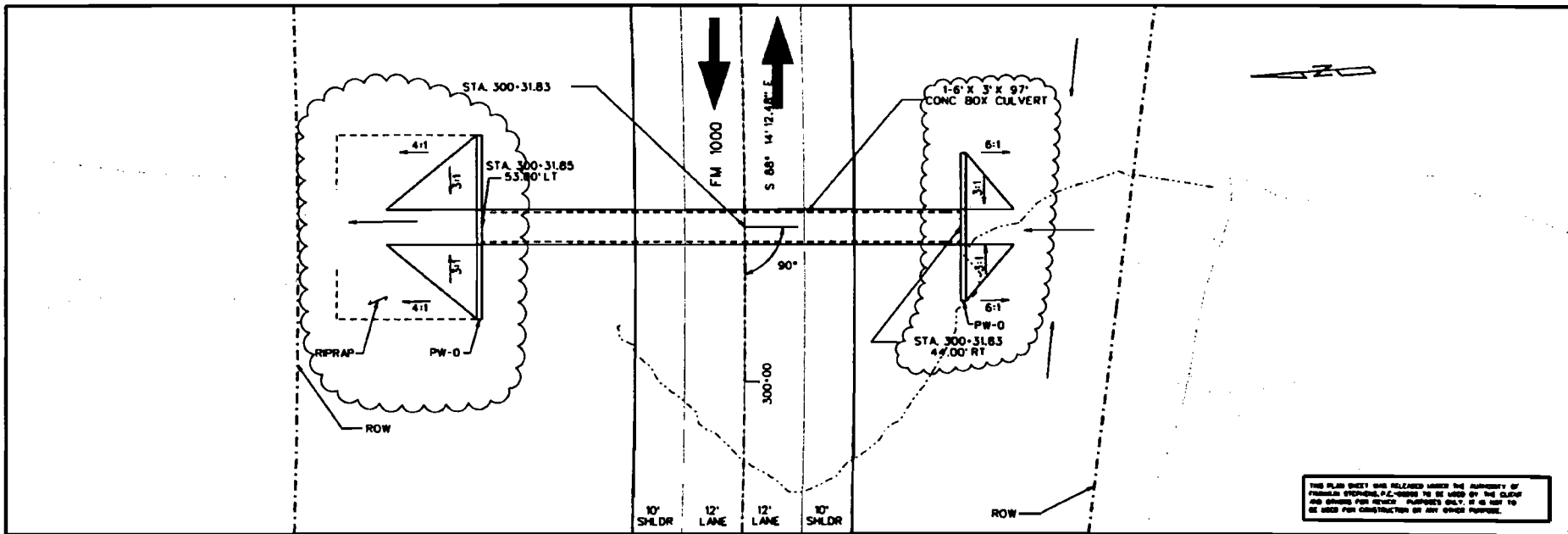

THIS PLAN SHEET HAS BEEN PREPARED UNDER THE AUTHORITY OF FERRIS ENGINEERING, P.C., WHICH IS TO BE USED BY THE CLIENT AND OWNERS FOR THEIR PURPOSES ONLY. IT IS NOT TO BE USED FOR CONSTRUCTION OF ANY OTHER PURPOSE.

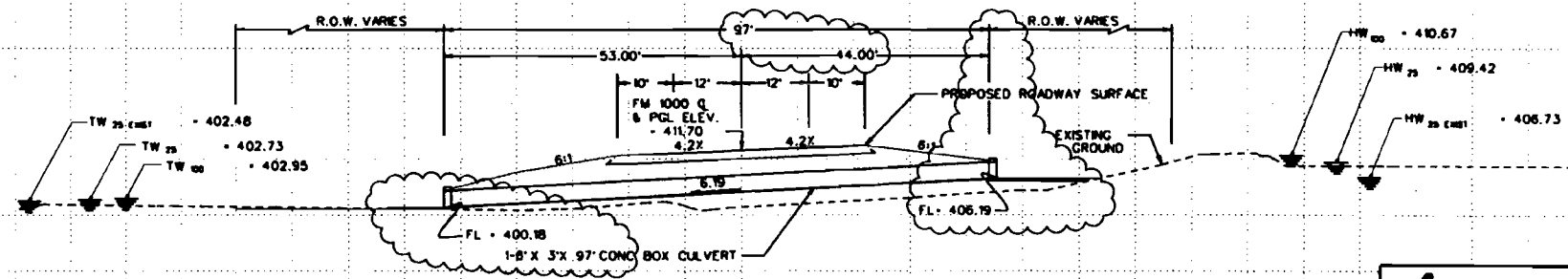

**CULVERT 13**  
 STATION 300+31.83  
 PROPOSED 1-6' X 3' X 97' CONC BOX CULVERT  
 W/ PW-0 US AND DS

HYDRAULIC DATA SUMMARY			
GEOPAK 2004 DRAINAGE 25 YR DESIGN			
Q <sub>25</sub>	= 107.52 cfs	Q <sub>100</sub>	= 117.11 cfs
V <sub>25</sub>	= 7.03 fps	V <sub>100</sub>	= 9.08 fps

Texas Department of Transportation  
 2010

**SPX**  
 SCHALMURG & POLK, INC.  
 BEAUMONT • HOUSTON • TYLER  
 530 S. BRIDGEMAN, SUITE 200 TYLER, TEXAS 75701  
 PHONE 409.835.2000 FAX 409.835.2003  
 FIRM REG. NO. 1-000020

**CULVERT 13 LAYOUT**  
 FM 1000 STA 300+31.83

SCALE: 1" = 20' SHEET 13 OF 22 SHEETS

DATE	ISSUED FOR PROJECT NO.	BY		
5				
DATE	DRY	CHECKED	DATE	BY
10/24/04	ALM	SPX	04/04/05	SPX







January 9, 2014

Mr. Rick Kronenberger, P.E.  
PTP Transportation  
1500 Research Forest Drive, Ste 200  
The Woodlands, TX 77381

RE: FM 1000  
Proposed US 271 Relief Route East – FM 1735  
Titus County  
TxDOT CSJ No: 1226-04-001

Subject: Change Order Request for Wingwall Revisions at sta. 300+31.83

Mr. Kronenberger:

Please accept the following prices associated with the changed wingwalls. The prices reflect the subcontractor prices plus the allowed 5% subcontractor markup, and 1% bond. Please see attached for justification from the subcontractor.

466-2048 Wingwall (PW)(HW=4) @ \$7,105.35/EA  
466-2050 Wingwall (PW)(HW=6) @ \$7,423.50/EA  
Work already completed on original Wingwall @ \$3,035.84/LS (revised)

Thanks

A handwritten signature in black ink, appearing to read "Scott N Pickett", written in a cursive style.

Scott N Pickett  
Project Manager  
James Construction Group  
318-957-9823 (mobile)

CC: Project Files

HIGHWAY 19 CONSTRUCTION

REVISED

P.O BOX 492

SULPHUR SPRINGS, TX 75482

CELL# (903)243-4187

FAX# (903)885-9782

*Breakdown of cost:*

LABORERS (6)	X	12 hr	X	\$12.00 per hour=	\$864.00
FOREMAN (2)	X	2 days	X	\$250.00 per day=	\$1,000
TRUCKS (2)	X	2 days	X	\$100.00 per day=	\$400.00
CAT EXCABATOR		2 days	X	\$300.00 per day=	<u>\$600.00</u>
				TOTAL:	\$2,864.00

Item No.	Description	Unit	January 31, 2014		Twelve Month Moving		Usage
			Quantity	Average Bid	Quantity	Average Bid	
466 2048	WINGWALL (PW) (HW=4 FT)	EA	10.000	8,844.00000	37.000	7,499.55216	14
466 2050	WINGWALL (PW) (HW=6 FT)	EA	1.000	23,000.00000	74.000	8,909.53905	23